



Tel: 0114 263 4422

Fax: 0114 263 4433

Email: info@shop4fasteners.co.uk

Web: <http://www.shop4fasteners.co.uk>

Heavy Duty Anchors Flat Head CSK Type C

Available in Mild steel zinc plated

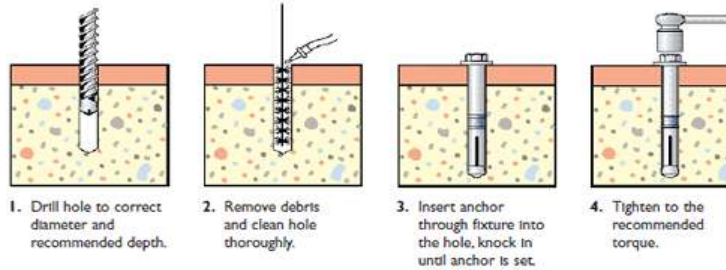

Size	Anchor Hole Dia. (mm)	Bolt Size (mm)	Hole Dia. In Fixture (mm)	Hole Dia. In Substrate (mm)	Min Hole Depth (mm)	Max Fixture Thickness mm	Min Substrate Thickness	Rec Tight Torque (Nm)	Safe Working Load in 30N/mm ² Concrete Tension/Shear
6 x 10	10	M6 x 65	12	10	60	10	100	15	4.9 / 5.3
6 x 25	10	M6 x 80	12	10	60	25	100	15	4.9 / 5.3
6 x 45	10	M6 x 100	12	10	60	45	100	15	4.9 / 5.3
8 x 10	12	M8 x 80	14	12	70	10	120	30	8.2 / 9.5
8 x 25	12	M8 x 95	14	12	70	25	120	30	8.2 / 9.5
8 x 50	12	M8 x 120	14	12	70	50	120	30	8.2 / 9.5
10 x 10	15	M10 x 90	16	15	85	10	140	50	10.6 / 12.6
10 x 25	15	M10 x 105	16	15	85	25	140	50	10.6 / 12.6
10 x 50	15	M10 x 130	16	15	85	50	140	50	10.6 / 12.6
12 x 20	18	M12 x 110	20	18	105	20	160	80	15.9 / 21.6
12 x 40	18	M12 x 130	20	18	105	40	160	80	15.9 / 21.6