



Tel: 0114 263 4422

Fax: 0114 263 4433

Email: info@shop4fasteners.co.uk

Web: <http://www.shop4fasteners.co.uk>

Heavy Duty Anchors Projecting Bolt Type B

Available in Mild steel zinc plated

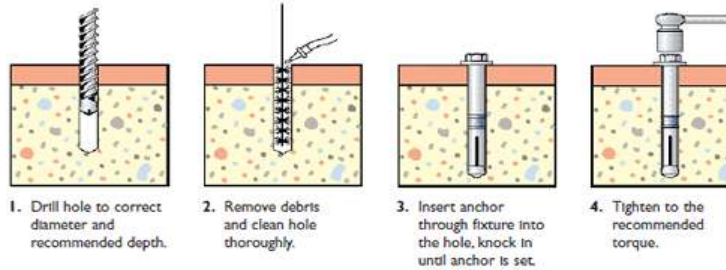

| Size | Anchor Hole Dia. (mm) | Bolt Size (mm) | Hole Dia. In Fixture (mm) | Hole Dia. In Substrate (mm) | Min Hole Depth (mm) | Max Fixture Thickness mm | Min Substrate Thickness | Rec Tight Torque (Nm) | Safe Working Load in 30N/mm ² Concrete Tension/Shear |
|---------|-----------------------|----------------|---------------------------|-----------------------------|---------------------|--------------------------|-------------------------|-----------------------|---|
| 6 x 10 | 10 | M6 x 65 | 12 | 10 | 65 | 10 | 100 | 15 | 4.9 / 5.3 |
| 6 x 30 | 10 | M6 x 80 | 12 | 10 | 65 | 30 | 100 | 15 | 4.9 / 5.3 |
| 6 x 50 | 10 | M6 x 110 | 12 | 10 | 65 | 50 | 100 | 15 | 4.9 / 5.3 |
| 8 x 10 | 12 | M8 x 80 | 14 | 12 | 80 | 10 | 120 | 30 | 8.2 / 9.5 |
| 8 x 30 | 12 | M8 x 95 | 14 | 12 | 80 | 30 | 120 | 30 | 8.2 / 9.5 |
| 8 x 50 | 12 | M8 x 120 | 14 | 12 | 80 | 50 | 120 | 30 | 8.2 / 9.5 |
| 10 x 10 | 15 | M10 x 90 | 16 | 15 | 95 | 10 | 140 | 50 | 10.6 / 12.6 |
| 10 x 25 | 15 | M10 x 110 | 16 | 15 | 95 | 25 | 140 | 50 | 10.6 / 12.6 |
| 10 x 40 | 15 | M10 x 130 | 16 | 15 | 95 | 45 | 140 | 50 | 10.6 / 12.6 |
| 12 x 10 | 18 | M12 x 100 | 20 | 18 | 105 | 10 | 160 | 80 | 15.9 / 21.6 |
| 12 x 20 | 18 | M12 x 120 | 20 | 18 | 105 | 20 | 160 | 80 | 15.9 / 21.6 |
| 12 x 40 | 18 | M12 x 140 | 20 | 18 | 105 | 40 | 160 | 80 | 15.9 / 21.6 |
| 16 x 10 | 24 | M16 x 120 | 26 | 24 | 130 | 10 | 200 | 160 | 23.5 / 34.5 |
| 16 x 20 | 24 | M16 x 140 | 26 | 24 | 130 | 20 | 200 | 160 | 23.5 / 34.5 |
| 16 x 50 | 24 | M16 x 160 | 26 | 24 | 130 | 50 | 200 | 160 | 23.5 / 34.5 |
| 20 x 10 | 28 | M20 x 150 | 30 | 28 | 160 | 10 | 250 | 200 | 35.6 / 51.6 |
| 20 x 30 | 28 | M20 x 170 | 30 | 28 | 160 | 30 | 250 | 200 | 35.6 / 51.6 |
| 20 x 60 | 28 | M20 x 190 | 30 | 28 | 160 | 60 | 250 | 200 | 35.6 / 51.6 |