



Tel: 0114 263 4422

Fax: 0114 263 4433

Email: info@shop4fasteners.co.uk

Web: <http://www.shop4fasteners.co.uk>

Sleeve Anchors Hex Bolt Type

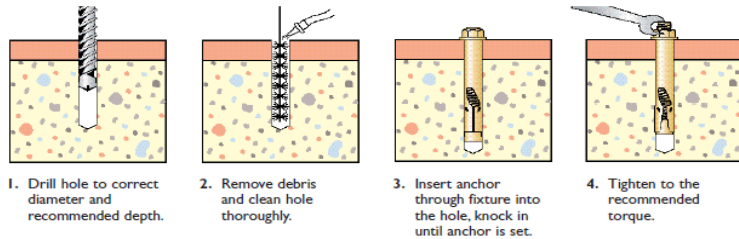

Available steel zinc plated.

Size	Anchor Hole Dia. (mm)	Bolt Size (mm)	Hole Dia. In Fixture (mm)	Hole Dia. In Substrate (mm)	Min Hole Depth (mm)	Max Fixture Thickness mm	Min Substrate Thickness	Rec Tight Torque (Nm)	Safe Working Load in 30N/mm ² Concrete Tension/Shear
8 x 45	8	M6 x 45	9-11	8	40	8	90	15	4.1 / 3.7
8 x 70	8	M6 x 70	9-11	8	40	30	90	15	4.1 / 3.7
8 x 90	8	M6 x 90	9-11	8	40	50	90	15	4.1 / 3.7
10 x 55	10	M8 x 55	11-12	10	45	10	100	35	5.7 / 6.1
10 x 80	10	M8 x 80	11-12	10	45	35	100	35	5.7 / 6.1
10 x 100	10	M8 x 100	11-12	10	45	60	100	35	5.7 / 6.1
12 x 65	12	M10 x 65	13-14	12	55	10	130	55	8.0 / 7.6
12 x 80	12	M10 x 80	13-14	12	60	25	130	55	8.0 / 7.6
12 x 100	12	M10 x 100	13-14	12	60	45	130	55	8.0 / 7.6
16 x 75	16	M12 x 75	17-18	16	60	15	170	85	11.0 / 10.2
16 x 110	16	M12 x 110	17-18	16	65	55	170	85	11.0 / 10.2