

Tel: 0114 263 4422
 Fax: 0114 263 4433
 Email: info@shop4fasteners.co.uk
 Web: http://www.shop4fasteners.co.uk

Sleeve Anchors Hex Nut Type

Available in Stainless Steel A4-316

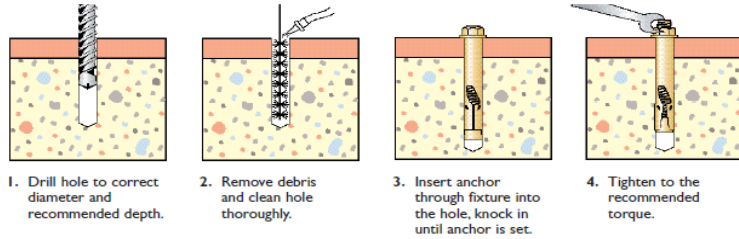

Size	Anchor Hole Dia. (mm)	Bolt Size (mm)	Hole Dia. In Fixture (mm)	Hole Dia. In Substrate (mm)	Min Hole Depth (mm)	Max Fixture Thickness mm	Min Substrate Thickness	Rec Tight Torque (Nm)	Safe Working Load in 30N/mm ² Concrete Tension/Shear
6 x 60	6	M4.5 x 60	7-8	6	35	28	60	5	1.5 / 1.4
8 x 40	8	M6 x 40	9-11	8	40	8	90	10	2.9 / 2.7
8 x 65	8	M6 x 65	9-11	8	40	30	90	10	2.9 / 2.7
10 x 50	10	M8 x 50	11-12	10	45	8	100	30	5.4 / 5.2
10 x 75	10	M8 x 75	11-12	10	45	35	100	30	5.4 / 5.2
10 x 100	10	M8 x 100	11-12	10	45	60	100	30	5.4 / 5.2
12 x 60	12	M10 x 60	13-14	12	55	15	130	60	8.0 / 8.3
12 x 75	12	M10 x 75	13-14	12	60	20	130	60	8.0 / 8.3
12 x 100	12	M10 x 100	13-14	12	60	45	130	60	8.0 / 8.3