

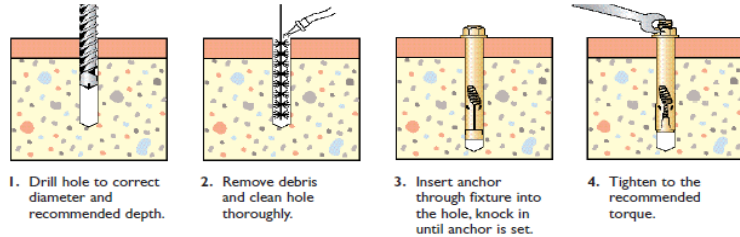

Tel: 0114 263 4422  
 Fax: 0114 263 4433  
 Email: [info@shop4fasteners.co.uk](mailto:info@shop4fasteners.co.uk)  
 Web: <http://www.shop4fasteners.co.uk>

## Sleeve Anchors Hex Nut Type

Available in Mild steel zinc plated



Size	Anchor Hole Dia. (mm)	Bolt Size (mm)	Hole Dia. In Fixture (mm)	Hole Dia. In Substrate (mm)	Min Hole Depth (mm)	Max Fixture Thickness mm	Min Substrate Thickness	Rec Tight Torque (Nm)	Safe Working Load in 30N/mm <sup>2</sup> Concrete Tension/Shear
6 x 26	6	M4.5 x 26	7-8	6	25	5	60	10	2.4 / 2.3
6 x 40	6	M4.5 x 40	7-8	6	35	8	60	10	2.4 / 2.3
6 x 60	6	M4.5 x 60	7-8	6	35	28	60	10	2.4 / 2.3
8 x 40	8	M6 x 40	9-11	8	40	8	90	15	4.1 / 3.7
8 x 65	8	M6 x 65	9-11	8	40	30	90	15	4.1 / 3.7
8 x 90	8	M6 x 90	9-11	8	40	55	90	15	4.1 / 3.7
10 x 40	10	M8 x 40	11-12	10	40	6	100	35	5.7 / 6.1
10 x 50	10	M8 x 50	11-12	10	45	10	100	35	5.7 / 6.1
10 x 75	10	M8 x 75	11-12	10	45	35	100	35	5.7 / 6.1
10 x 100	10	M8 x 100	11-12	10	45	60	100	35	5.7 / 6.1
10 x 125	10	M8 x 125	11-12	10	45	85	100	35	5.7 / 6.1
12 x 60	12	M10 x 60	13-14	12	55	15	130	55	8.0 / 7.6
12 x 75	12	M10 x 75	13-14	12	55	20	130	55	8.0 / 7.6
12 x 100	12	M10 x 100	13-14	12	55	50	130	55	8.0 / 7.6
12 x 125	12	M10 x 125	13-14	12	55	75	130	55	8.0 / 7.6
16 x 65	16	M12 x 65	17-18	16	60	15	170	85	11.0 / 10.2
16 x 110	16	M12 x 110	17-18	16	60	55	170	85	11.0 / 10.2
16 x 145	16	M12 x 145	17-18	16	60	85	170	85	11.0 / 10.2
20 x 80	20	M16 x 80	21-22	20	65	20	210	165	13.6 / 12.4
20 x 115	20	M16 x 115	21-22	20	65	55	210	165	13.6 / 12.4
20 x 160	20	M16 x 160	21-22	20	65	100	210	165	13.6 / 12.4