

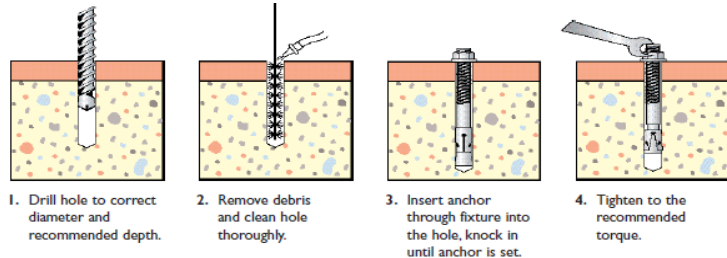

Tel: 0114 263 4422
Fax: 0114 263 4433
Email: info@shop4fasteners.co.uk
Web: <http://www.shop4fasteners.co.uk>



Throughbolt Stainless Steel A4-316

Available in stainless steel A4-316

Size	Anchor Hole Dia. (mm)	Anchor Length (mm)	Hole Dia. In Fixture (mm)	Hole Dia. In Substrate (mm)	Min Hole Depth (mm)	Max Fixture Thickness mm	Min Substrate Thickness	Rec Tight Torque (Nm)	Safe Working Load in 30N/mm ² Concrete Tension/Shear
6 x 40	6	40	7-8	6	35	5	100	10	3.6 / 4.0
6 x 52	6	52	7-8	6	45	5	100	10	3.6 / 4.0
6 x 67	6	67	7-8	6	55	10	100	10	3.6 / 4.0
6 x 82	6	82	7-8	6	55	25	100	10	3.6 / 4.0
6 x 97	6	97	7-8	6	55	40	100	10	3.6 / 4.0
8 x 50	8	50	9-10	8	45	5	100	20	5.7 / 6.9
8 x 60	8	60	9-10	8	50	10	100	20	5.7 / 6.9
8 x 75	8	75	9-10	8	65	10	100	20	5.7 / 6.9
8 x 95	8	95	9-10	8	55	30	100	20	5.7 / 6.9
8 x 120	8	120	9-10	8	55	55	100	20	5.7 / 6.9
10 x 60	10	60	11-12	10	50	10	110	45	7.6 / 8.0
10 x 85	10	85	11-12	10	70	10	110	45	7.6 / 8.0
10 x 95	10	95	11-12	10	70	20	110	45	7.6 / 8.0
10 x 105	10	105	11-12	10	70	30	110	45	7.6 / 8.0
10 x 125	10	125	11-12	10	70	50	110	45	7.6 / 8.0
10 x 145	10	145	11-12	10	70	70	110	45	7.6 / 8.0
10 x 175	10	175	11-12	10	70	100	110	45	7.6 / 8.0
12 x 75	12	75	13-14	12	65	5	135	65	11.9 / 15.4
12 x 95	12	95	13-14	12	80	10	135	65	11.9 / 15.4
12 x 110	12	110	13-14	12	90	15	135	65	11.9 / 15.4
12 x 125	12	125	13-14	12	90	30	135	65	11.9 / 15.4



Tel: 0114 263 4422
Fax: 0114 263 4433
Email: info@shop4fasteners.co.uk
Web: <http://www.shop4fasteners.co.uk>

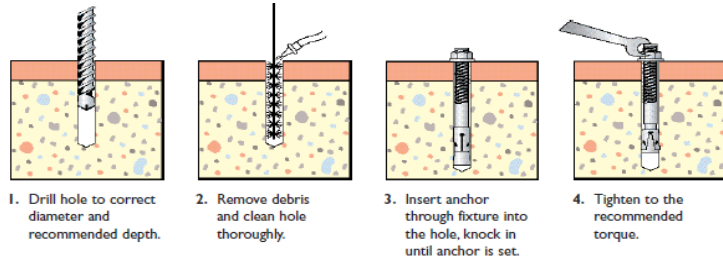

Throughbolt Stainless Steel A4-316

Available in Stainless Steel A4-316

Size	Anchor Hole Dia. (mm)	Anchor Length (mm)	Hole Dia. In Fixture (mm)	Hole Dia. In Substrate (mm)	Min Hole Depth (mm)	Max Fixture Thickness mm	Min Substrate Thickness	Rec Tight Torque (Nm)	Safe Working Load in 30N/mm ² Concrete Tension/Shear
12 x 145	12	145	13-14	12	90	50	135	65	11.9 / 15.4
12 x 160	12	160	13-14	12	90	65	135	65	11.9 / 15.4
12 x 180	12	180	13-14	12	90	85	135	65	11.9 / 15.4
12 x 200	12	200	13-14	12	90	105	135	65	11.9 / 15.4
16 x 90	16	90	17-18	16	75	5	180	150	17.2 / 28.6
16 x 115	16	115	17-18	16	90	15	180	150	17.2 / 28.6
16 x 130	16	130	17-18	16	110	30	180	150	17.2 / 28.6
16 x 150	16	150	17-18	16	110	50	180	150	17.2 / 28.6
16 x 180	16	180	17-18	16	110	80	180	150	17.2 / 28.6
16 x 200	16	200	17-18	16	110	100	180	150	17.2 / 28.6
20 x 150	20	150	21-22	20	130	5	210	250	24.0 / 43.9
20 x 180	20	180	21-22	20	130	35	210	250	24.0 / 43.9
20 x 205	20	205	21-22	20	130	60	210	250	24.0 / 43.9
20 x 240	20	240	21-22	20	130	95	210	250	24.0 / 43.9